

Special Exhibition

Themes in Japanese Art from the Imperial Collection

August 6 – September 25, 2022

The University Art Museum,
Tokyo University of the Arts

Organizers: The University Art Museum, Tokyo University of the Arts,
The Museum of the Imperial Collections, Sannomaru Shōzōkan, The Yomiuri Shimbun

With the Special Sponsorship of: Canon Inc., Daiwa Securities Group, Mitsui Fudosan Co.,Ltd.,
MITSUBISHI ESTATE CO.,LTD., Meiji Holdings Co.,Ltd.

With the Sponsorship of: East Japan Railway Company, SHIMIZU CORPORATION,
Takashimaya Co.,Ltd., TAKENAKA CORPORATION, Sumitomo Mitsui Banking Corporation,
Mitsubishi Corporation

With the Special Support of: Agency for Cultural Affairs, TSUMUGU Project

With the Support of: Aioi Nissay Dowa Insurance Co.,Ltd.



List of Works

[Notes]

• The same artwork numbers are used in both the catalogue and the galleries, but the works are not displayed in numerical order. • Designations are indicated as follows: ●= National Treasure, ◎= Important Cultural Property • Some artworks may be rotated during the exhibition period. Exhibition lineup may change as circumstances require. • Works are on view throughout the exhibition period unless otherwise indicated. • Works with * are owned by the Tokyo University of the Arts, and all others without description are from the Museum of the Imperial Collections, Sannomaru Shōzōkan.

To our visitors: Please do not;

• reenter. • touch art works and display cases. • make sketches. • take videos and pictures. • use pens or brushes that may mark or damage the art works. • make phone calls.

No.	Title	Creator	Dates/Era	Quantity	Owner	Term
1	Cabinet with Design of Chrysanthemums	Rokkaku Shisui (design), Kawanobe Icchō, and others (<i>makie</i>), Unno Shōmin (metal fittings)	1903	1 cabinet		
2	Notebook of Okakura Tenshin's Lecture on History of Japanese Art, written down by Hara Yasutami		1891	2 notebooks	*	
3	Architectural Model of Hōryūji Temple Main Hall		1910	1 model	*	
4	Rubbed copy of statue of Kuse Kannon, principal image of Yumedono (Hall of Dreams) of Hōryūji Temple		before 1918	1 handscroll	*	scene change (-Sep.4/Sep.6-)
5	Rubbed copy of statues of Shitennō (Four guardian kings), Tachibana bunin nenjibutsu, and others of Hōryūji Temple Main Hall		before 1918	1 handscroll	*	scene change (-Sep.4/Sep.6-)
Refer- ence exhibit work	Reproduction(collotype) of Hōryūji Temple Main Hall Wall Paintings		1937	among 12 hanging scrolls	*	

Chapter 1—Japanese Art Evolving from Letters

6	Hokke-kyō Sutra Vol.2		Nara period, 8th century	1 handscroll		scene change (-Sep.4/Sep.6-)
7	● Illustrated Sutra of Past and Present Karma		Nara period, 8th century	1 handscroll	*	scene change (-Sep.4/Sep.6-)
8	● Byōbu-dodai (Draft for Screen Poem)	Ono no Michikaze	928	1 handscroll		Sep.6-
9	Onmeijō (Letter)	Fujiwara no Sukemasa	982	1 handscroll		-Sep.4
10	Wakan Rōeishū (Anthology of Japanese and Chinese Verses for Recitation) in Detchō Style Binding	Attributed to Fujiwara no Yukinari	Heian period, 11th century	2 books		scene change*
11	Wakan Rōeishū (Anthology of Japanese and Chinese Verses for Recitation) in Handscroll Style	Attributed to Fujiwara no Kintō	Heian period, 12th century	2 handscrolls		scroll change (Vol. 1: -Sep.4/Vol. 2: Sep.6-)
12	Documents on Prince Atsuyasu's First Audience with Emperor Ichijō	Fujiwara no Yukinari	1005	1 hanging scroll		Sep.6-
13	Kokin Wakashū (Anthology of Ancient and Modern Japanese Poems), Three Poems of Celebration	Attributed to Fujiwara no Kintō	Heian period, 12th century	1 hanging scroll		-Sep.4

*No.10 Scenes of Wakan Rōeishu will differ in the next three terms: Aug.6 - 28 / Aug. 30–Sep.4 / Sep.6 –25.

No.	Title	Creator	Dates/Era	Quantity	Owner	Term
14	Scenes from the Tale of Genji	Attributed to Kanō Eitoku	Momoyama period, 16-17th century	1 pair of six-fold screens		–Sep.4
15	Album of the Tale of Genji	Attributed to Tosa Mitsunori	Edo period, 17th century	1 book		scene change (–Sep.4/Sep.6–)
16	Set of Stationery Stand and Ink-stone Box with Design of Writing the Tale of Genji at Ishiyama Temple in <i>Makie</i>	Kishi Kōkei (design), Kawanobe Icchō (<i>makie</i>)	1899	1 set		Sep.6–
17	Set of Stationery Stand and Ink-stone Box with Narrow Ivy Road Design in <i>Makie</i>		Edo period, 17th century	1 set		–Sep.4
18	Scenes from the Tale of Ise	(right screen) Takatori Wakanari, Maeda Ujizane, (left screen) Kobori Tomoto, Kikkawa Reika	1916	1 pair of six-fold screens		scene change (right screen: –Sep.4/left screen: Sep.6–)
19	Scattered Painted Fans	Tawaraya Sōtatsu	Edo period, 17th century	1 pair of eight-fold screens		Sep.6–
20	● Illustrated Scrolls of the Mongol Invasions		Kamakura period, 13th century	2 handscrolls		scroll change (Vol. 1: –Sep.4/Vol. 2: Sep.6–)
21	Story of a Painter		Kamakura period, 14th century	1 handscroll		scene change (–Sep.4/Sep.6–)
22	● Kasuga Gongen Genki-e (Legends of Kasuga Shrine), Vol. 4, 5	Takashina Takakane	c. 1309	2 handscrolls (from a set of 20 handscrolls)		scroll change (Vol. 4: –Sep.4/Vol. 5: Sep.6–)
23	Kitano Tenjin Engi Emaki (Legends of Kitano Tenjin Shrine) (In Three Volumes), Vol. 2, 3		Muromachi period, 16th century	2 handscrolls (from a set of 3 handscrolls)		scroll change (Vol. 2: –Sep.4/Vol. 3: Sep.6–)
24	Portrait of Ono no Michikaze	Attributed to Raiju	Kamakura period, 13th century	1 hanging scroll		Sep.6–
25	Portrait of Kakinomoto no Hitomaro		Muromachi period, 15th century	1 hanging scroll		–Sep.4
26	Illustrated Scrolls of the Tale of Priest Saigyō, Vol. 3	Ogata Kōrin	Edo period, 18th century	1 handscroll (from a set of 4 handscrolls)		scene change (–Sep.4/Sep.6–)
27	Bugaku Dancer, Taiheiraku	Unno Shōmin	1899	1 figure		
28	Court Lady	Asahi Gyokuzan	1901	1 figure		–Sep.4
29	Falconer	Ishikawa Mitsuaki	1899	1 figure		Sep.6–
30	Kamo Horse Race	Yamazaki Chōun	1924	1 figure		
31	Okuri—Illustrated Scrolls of Oguri Hangan, Vol.1, 2	Iwasa Matabei	Edo period, 17th century	2 handscrolls (from a set of 15 handscrolls)		scroll change (Vol. 1: –Sep.4/Vol. 2: Sep.6–)
32	Illustrated Scrolls of Shutendōji (the Ogre), Vol.2, 4		Edo period, 17th century	2 handscrolls (from a set of 5 scrolls)		scroll change (Vol. 2: –Sep.4/Vol. 4: Sep.6–)
33	Architectural Model of Hō-ōdō Hall (Phoenix Hall) of Byōdōin Temple		1910	1 model	*	

Chapter 3—Sentiments Towards Living Beings

34	● Chinese Lions	(right screen) Kanō Eitoku, (left screen) Kanō Tsunenobu	(right screen) Momoyama period, 16th century, (left screen) Edo period, 17th century	1 pair of six-fold screens		–Aug.28
35	● Dōshoku Sai-e (Colorful Realm of Living Beings) Herbaceous Peonies and Butterflies / Birds on Plum Blossoms / Rooster, Sunflowers and Morning Glories / Hydrangeas with Fowls / White Fowls and Pine / White Goose and Reeds / Fish in a Lotus Pond / Birds on Blossoming Peach Tree / Insects and Reptiles at a Pond / Wild Goose and Snow-covered Reeds	Itō Jakuchū	c. 1757–c. 1766	10 hanging scrolls (from a set of 30 hanging scrolls)		Aug.30–

No.	Title	Creator	Dates/Era	Quantity	Owner	Term
36	Peonies and Peacocks	Maruyama Ōkyo	1776	1 hanging scroll		Aug.30-
37	Dogs and Morning Glories	Yamaguchi Soken	1792	1 hanging scroll		-Aug.28
38	Cat and Cotton Plants	Nagasawa Rosetsu	Edo period, 18th century	1 hanging scroll		-Aug.28
39	Monkeys	Mori Sosen	Edo period, 18-19th century	3 hanging scrolls		-Aug.28
40	Tiger	Tani Bunchō	Edo period, 19th century	1 hanging scroll		Aug.30-
41	Album of Scenes by Famous Edo Painters	Mashiyama Sessai and others	c. 1817	1 set of 2 albums		scene change (-Aug.28/Aug.30-)
42	Birds and Flowers through the Twelve Months	Sakai Hōitsu	1823	12 hanging scrolls		-Aug.28
43	Drying Watermelon Rinds	Katsushika Hokusai	1839	1 hanging scroll		-Aug.28
44	◉ Salmon	Takahashi Yuichi	c. 1877	1 framed painting	*	
45	Sunrise and Pair of Cranes	Araki Kanpo	1894	1 hanging scroll (from a set of 3 hanging scrolls)		Aug.30-
46	Moon and Turtle	Hoshino Sensui	Meiji period, 19th century	1 hanging scroll		Aug.30-
47	Paulownia and Phoenixes	Kawabata Gyokushō	1900	1 hanging scroll		Aug.30-
48	Dragons Soaring throughout the World	Yokoyama Taikan	1936	1 pair of six-fold screens		-Aug.28
49	Autumn Eggplants and Foxes	Nishimura Goun	1932	1 hanging scroll		Aug.30-
50	Poetry of Each Passing Day	Hashimoto Kansetsu	1934	1 hanging scroll		Aug.30-
51	Vases with Design of a Hundred Cranes	Kanō Natsuo	1890	1 pair		
52	Vase with Design of Ice and Plum Blossoms in Cobalt Underglaze	Miyagawa Kōzan I	1894	1 vase		
53	Lidded Container in Egg Shape with Butterfly Design in Gold and Multicolored Overglaze	Itō Tōzan I	1880-90's	1 piece		
54	Incense Caddy with Lotus Design in <i>Makie</i>	Shirayama Shōsai	1904	1 piece		
55	Incense Burner with Design of Dragonfly and Kōhone (type of water lily)	Kawade Shibatarō	1906	1 piece		
56	Bantams	Takamura Kōun	1889	1 pair		-Aug.28
57	Deer	Takamura Kōun	1920	1 figure		Aug.30-
58	Gamecock		c. 1906	1 figure		
59	Weasel		Meiji period, 19th century	1 figure		
60	Feather Duster and Puppy		Meiji to Taisho periods, 20th century	1 figure		-Aug.28
61	Persimmon	Andō Ryokuzan	1920	1 figure		Aug.30-
62	Carp	Ōshima Joun	Taisho to early Showa periods, 20th century	1 figure		
63	Cow and Boy	Numata Ichiga	Taisho to early Showa periods, 20th century	1 figure		
64	White Porcelain Kirin	Sakaida Kakiemon XII	1928	1 figure		
65	Sheep	Kitahara Senroku	1928	1 figure		
66	Rabbit	Sugita Kadō (model), Kōgei Seikeisha (cast)	1937	1 figure		
67	Vase with Flower and Bird Design in Hokō Saiji (a unique technique with relief coated with a type of mat glaze) Porcelain	Itaya Hazan	1928	1 vase		
68	Vase with Flat Peach Design in Saien (modeled color clay) Technique	Kusube Yaichi	1938	1 vase		

No.	Title	Creator	Dates/Era	Quantity	Owner	Term
69	Beach and Pines	Kaihō Yūshō	1605	1 pair of six-fold screens		-Aug.28
70	Drying Fish Nets	Kaihō Yūshō	c. 1602	1 pair of six-fold screens		-Aug.28
71	Set of Stationery Box and Ink-stone Box with Uji River and Firefly Design in <i>Makie</i>	Iizuka Tōyō I	1775	1 set		-Aug.28
72	Set of Stationery Stand, Stationery Box and Ink-stone Box with Mountain Road and Chrysanthemum Design in <i>Makie</i>	Kawabata Gyokushō (design), Ikeda Taishin (production), Tsukada Shūkyō (metal fittings)	(stationery box, ink-stone box) 1893, (stationery stand) 1896	1 set		Aug.30-
73	Vase with Design of Birds and Flowers of the Four Seasons	Namikawa Yasuyuki	1899	1 vase		
74	Panel of Mt. Fuji	Namikawa Sōsuke	1894	1 panel		
75	Autumn Refresh	Kosaka Shiden	1912	1 ten-fold screen		Aug.30-
76	Sunny Autumn Day	Ikegami Shūho	1915	1 pair of six-fold screens		Aug.30-
77	After the Rain	Kawai Gyokudō	1924	1 hanging scroll		-Aug.28
78	Cascading Water	Yokoyama Taikan	1928	1 pair of hanging scrolls		Aug.30-
79	Scene of Niagara	Goseda Yoshimatsu	1889	1 framed painting		
80	Kurikoyama Tunnel	Takahashi Yuichi	1881	1 framed painting		
81	Smoke from Rural Village Houses	Nakamura Fusetsu	1898	1 framed painting		
82	Twilight	Wada Eisaku	1914	1 framed painting		

[Floor Plan]

· Temperature, humidity and brightness of the exhibition rooms are strictly controlled under international standards for preservation. We apologize for any inconvenience this may cause.

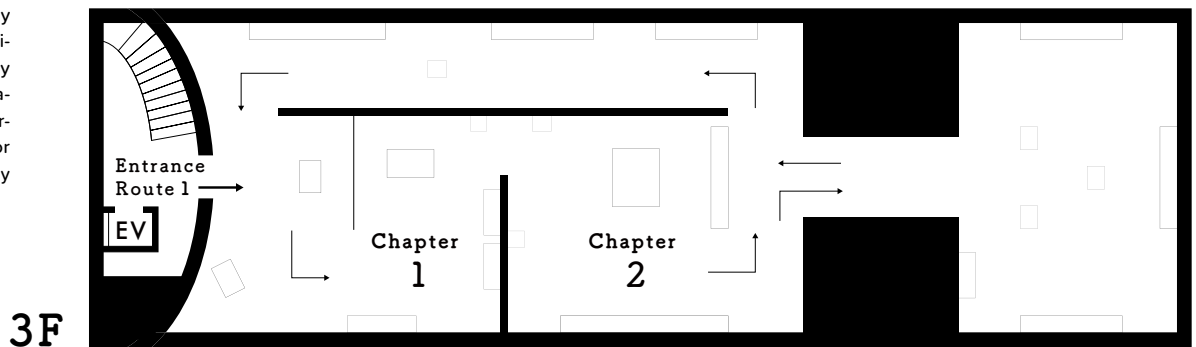

B2F

