

List of Works

Special Exhibition

HÖNEN AND PURE LAND BUDDHISM

April 16 – June 9, 2024 | Heiseikan, Tokyo National Museum

Organizers: Tokyo National Museum; NHK; NHK Promotions Inc.; The Yomiuri Shimbun
Special Sponsors: Canon Inc.; Daiwa Securities Group; T&D Insurance Group; Meiji Holdings Co., Ltd.
Sponsors: East Japan Railway Company; SHIMIZU CORPORATION; TAKENAKA CORPORATION;
Sumitomo Mitsui Banking Corporation; Mitsui Fudosan Co., Ltd.; MITSUBISHI GAS CHEMICAL CO., INC.;
MITSUBISHI ESTATE CO., LTD.; Mitsubishi Corporation
Special Supporters: Jōdo Shū 850th Anniversary Celebration Committee; Agency for Cultural Affairs
Supporter: Nissha Co., Ltd.

A part of the proceeds from the exhibition will be used in a scheme under the TSUMUGU Project to help repair Japan's cultural properties.



Notes

- This exhibition will also be held at the Kyoto National Museum from October 8 – December 1, 2024 and at the Kyushu National Museum from October 7 – November 30, 2025.
 - The same artwork numbers are used in both the catalogue and the galleries, but the works are not displayed in numerical order. The numbers missing from this list below indicate works, which will be exhibited exclusively at the Kyoto or Kyushu venue.
 - Designations identified by: ● National Treasure, ◎ Important Cultural Property.
 - Some artworks may be rotated during the exhibition period. Exhibition lineup may change as required by circumstances.
- Artworks are on view throughout the exhibition period unless otherwise indicated.
The rotation schedule is as follows:
- | | |
|----------------------------------|----------------------------------|
| Term ① 4/16 (Tue.) – 4/21 (Sun.) | Term ② 4/23 (Tue.) – 4/29 (Mon.) |
| Term ③ 4/30 (Tue.) – 5/6 (Mon.) | Term ④ 5/8 (Wed.) – 5/12 (Sun.) |
| Term ⑤ 5/14 (Tue.) – 5/19 (Sun.) | Term ⑥ 5/21 (Tue.) – 5/26 (Sun.) |
| Term ⑦ 5/28 (Tue.) – 6/2 (Sun.) | Term ⑧ 6/4 (Tue.) – 6/9 (Sun.) |

Chapter I. Hōnen and His Time

1 ◎ *Collected Essays on Birth in the Pure Land (Ōjōyōshū)*

Heian period, dated 1171 (Jōan 1)
Shōren-in Temple, Kyoto

Volume 1: ① – ④
Volume 3: ⑤ – ⑧

2 *Collected Essays on Birth in the Pure Land (Ōjōyōshū), Volume 5*

Muromachi period, 15th century

① – ④ / ⑤ – ⑧

3 *Portrait of the Priest Genshin, also known as Eshin Sōzu*

Nanbokuchō period, 14th century
Shōjuraikō-ji Temple, Shiga

① – ④

4 ◎ *Japanese Record of Births in Paradise (Nihon ōjō gokuraku ki)*

Heian period, dated 1086 (Ōtoku 3)
Tenri Central Library, Nara

① – ④

5 ◎ *Letter by Yoshishige no Yasutane*

Heian period, 10th–11th century
Tokyo National Museum

⑤ – ⑧

11 *The Three Pure Land Sutras (Jōdo sanbukyō)*

Sutra on the Buddha of Infinite Life, Volumes 1 and 2; *Contemplation Sutra*; *Amitābha Sutra*
Kamakura period, 12th–13th century
Shōjōke-in Temple, Kyoto

① – ④ / ⑤ – ⑧

15 ◎ *Seated Portrait of Master Hōnen*

Kamakura period, 14th century
Taima-dera Oku-no-in Temple, Nara

① – ④

16 *Seated Portrait of Master Hōnen*

Kamakura period, 13th century
Hyakumanben Chion-ji Temple, Kyoto

18 *Standing Portrait of Master Hōnen*

Kamakura period, 14th century
Shin Chion-in Temple, Shiga

19 *Buddha Entering Nirvana*

Kamakura period, 13th century
Shin Chion-in Temple, Shiga

20 ◎ *Portrait of Master Hōnen, known as Ashibiki no mie*

Kamakura period, 13th century
Nison-in Temple, Kyoto

① – ④

22 *Portrait of Master Hōnen, known as Takanobu no mie*

Kamakura period, 14th century
Chion-in Temple, Kyoto

23 *Portrait of Master Hōnen*

Presumably inscribed by Hōnen (1133–1212)
Kamakura period, 13th–14th century
Zendō-ji Temple (Kurume City), Fukuoka

① – ④

24 *Portrait of Master Hōnen*

Presumably inscribed by Hōnen (1133–1212)
Kamakura period, 14th century
Chion-in Temple, Kyoto

⑤ – ⑧

25 ㊦

Portrait of Master Hōnen

Kamakura period, 14th century
Jōfuku-ji Temple, Ibaraki

⑤⑥

26 ㊦

**Illustrated Biography of Master Hōnen
(Hōnen Shōnin e-den)**

Kamakura period, 14th century
Chion-in Temple, Kyoto

Volumes 6 and 14: ① – ④

Volumes 31 and 42: ⑤ – ⑧

27 ㊦

**Illustrated Biography of Master Hōnen
(Hōnen Shōnin e-den)**

Muromachi period, 15th century
Taima-dera Oku-no-in Temple, Nara

Volumes 18 and 19: ① – ④

Volumes 1 and 34: ⑤ – ⑧

28

**Transmission of the Teachings (Denpō-e
ruzū), also known as Illustrated Life of the
Japanese Founder [Hōnen] (Honchō soshi
denki ekotoba)**

Muromachi period, 16th century
Zendō-ji Temple (Kurume City), Fukuoka

Volume 1: ① – ④

Volume 4: ⑤ – ⑧

29

**Fragments of Transmission of the Teachings
(Denpō-e ruzū)**

Kamakura period, 14th century
Okayama Prefectural Museum

“Dinner in Shiaku Village,”

“The Imperial Pardon,” and “Enshrining a Set
of the Complete Buddhist Canon” Scenes: ① – ④

“Hōnen delivering a Sermon at Katsuō-ji Temple,”

“The Appearance of a Heavenly Acolyte and
Blossoming of Lotus at Hōnen’s Grave in

Ōtani,” and “Hōnen at His Deathbed” Scenes: ⑤ – ⑧

31

**Fragment of Transmission of the Teachings
(Denpō-e ruzū): “Honen’s Return to Kyoto”
Scene**

Kamakura period, 14th century

① – ④

33 ㊦

**Illustrated Biography of Master Hōnen
(Hōnen Shōnin e-den)**

Kamakura period, 13th century
Zōjō-ji Temple, Tokyo

Volume 1: ① – ④

Volume 2: ⑤ – ⑧

34 ㊦

**Illustrated Biography of Master Hōnen
(Hōnen Shōnin e-den), Rinna Version**

Kamakura period, 14th century
Tokyo National Museum

Volume 7: ① – ④

Volume 8: ⑤ – ⑧

35

**Illustrated Life of Master Hōnen (Hōnen
Shōnin den ekotoba), Rinna Version,
Volumes 3 and 4**

Edo period, 17th century
Myōjō-in Temple, Tokyo

① – ④ / ⑤ – ⑧

38 ㊦

**Illustrated Gleanings of the Virtuous Monk
[Hōnen] (Shūi kotokuden e)**

Kamakura period, dated 1323 (Genkō 3)
Jōfuku-ji Temple, Ibaraki

Volume 3: ① – ④

Volume 5: ⑤ – ⑧

39 ㊦

**Illustrated Biography of Master Hōnen
(Hōnen Shōnin e-den)**

Kamakura period, 14th century
Saidō-ji Temple, Mie

① – ⑤

40 ㊦

**Illustrated Biography of Master Hōnen
(Hōnen Shōnin e-den)**

Kamakura period, 14th century
Yamanashi Prefectural Museum

⑥ – ⑧

41

**Scene of Master Hōnen’s Birth into the
Pure Land (Hōnen Shōnin ōjō zu)**

Nanbokuchō–Muromachi period, 14th–15th
century

Tōryū-ji Temple, Aichi

⑤ – ⑧

42

**Scene of Master Hōnen Entering Nirvana
(Hōnen Shōnin nehan zu)**

Edo period, 17th century
Hyakumanben Chion-ji Temple, Kyoto

① – ④

43

**Scene of Master Hōnen Entering Nirvana
(Hōnen Shōnin nehan zu)**

Edo period, 17th century
Konkai Kōmyō-ji Temple, Kyoto

⑤ – ⑧

44 ㊦

**Passages on the Selection of the Nenbutsu
in the Original Vow (Senchaku hongan
nenbutsu shū), Rozan-ji Version**

Kamakura period, 12th–13th century
Rozan-ji Temple, Kyoto

① – ④

45 ㊦

**Passages on the Selection of the Nenbutsu
in the Original Vow (Senchaku hongan
nenbutsu shū), Ōjō-in Version**

Kamakura period, dated 1204 (Genkyū 1)
Taima-dera Oku-no-in Temple, Nara

⑤ – ⑧

46-1 ㊦

Seven Article Pledge (Shichikajō seikai)

Kamakura period, dated 1204 (Genkyū 1)
Nison-in Temple, Kyoto

① – ④

47 ㊦

**Mandala of Amida (Amitābha) and Retinue
Welcoming the Devotee to the Pure Land
(Gōshō mandara)**

Kamakura period, 12th–13th century
Seiryō-ji Temple, Kyoto

① – ④

48 ㊦

**Mandala of Amida (Amitābha) and Retinue
Welcoming the Devotee to the Pure Land
(Gōshō mandara), Reproduction**

Nanbokuchō period, 14th century
Seiryō-ji Temple, Kyoto

⑤ – ⑧

49 ㊦

Vows Handwritten by Kumagai Naozane

By Kumagai Naozane (1141–1208)
Kamakura period, 13th century

Seiryō-ji Temple, Kyoto

⑤ – ⑧

50 ㊦

**Origin of the Mandala of Amida
(Amitābha) and Retinue Welcoming the
Devotee to the Pure Land (Gōshō mandara
yurai)**

Kamakura period, 13th century
Seiryō-ji Temple, Kyoto

① – ④

51 ㊦

**Letters by the Priests Genkū (Hōnen) and
Shōkū**

Kamakura period, 13th century
Seiryō-ji Temple, Kyoto

① – ④

53-2 ㊦

**Votive Objects Deposited in Jizō Statue:
Sutra of Innumerable Meanings (Muryōgi
kyō) as a Karmic Connection Sutra with
Each Line Copied by Different Monks**

Heian–Kamakura period, 12th century
Saikō-ji Temple, Aichi

⑤ – ⑧

55 ㊦

**Seated Portrait of Master Shandao
(J: Zendō Daishi)**

Kamakura period, 13th century
Raikō-ji Temple, Nara

⑤ – ⑧

58 ㊦

**Portrait of Master Shandao
(J: Zendō Daishi)**

Kamakura period, 13th century
Hyakumanben Chion-ji Temple, Kyoto

① – ④

59

Embroidered Portrait of Master Shandao (J: Zendō Daishi) (in Portable Altar)

Nanbokuchō–Muromachi period, 14th–15th century

Taima-dera Nenbutsu-in Temple, Nara

⑤ – ⑧

60

Mandala of the Two Patriarchs, Hōnen and Shandao (*Niso mandara*)

Nanbokuchō period, 14th century

Chion-in Temple, Kyoto

① – ④

63 ◎

The Two Rivers and the White Path (*Niga byakudō*)

Kamakura period, 13th century

Kōmyō-ji Temple, Kyoto

① – ④

64 ◎

The Two Rivers and the White Path (*Niga byakudō*)

Kamakura period, 13th century

Kosetsu Museum of Art, Hyogo

⑤ – ⑧

66

The Five Chinese Pure Land Patriarchs

Kamakura period, 14th century

Hyakumanben Chion-ji Temple, Kyoto

① – ④

69

The Five Chinese Pure Land Patriarchs

China, Yuan dynasty or Japan, Nanbokuchō period, 14th century

Shōjōke-in Temple, Kyoto

⑤ – ⑧

71 ◎

Illustrated Biography of the Five Chinese Pure Land Patriarchs (Jōdo goso e-den)

Kamakura period, dated 1305 (Kagen 3)

Kōmyō-ji Temple, Kanagawa

⑤ – ⑧

72 ◎

Illustrated Biography of the Five Chinese Pure Land Patriarchs (Jōdo goso e)
The Life of Master Shandao

Nanbokuchō period, 14th century

Kōmyō-ji Temple, Kanagawa

① – ④

73

Illustrated Biography of the Five Chinese Pure Land Patriarchs (Jōdo goso e)
The Life of Master Tanluan

Nanbokuchō period, 14th century

① – ④ / ⑤ – ⑧

74

Fragment of *Illustrated Biography of the Five Chinese Pure Land Patriarchs (Jōdo goso e)*

Nanbokuchō period, 14th century

① – ④

**Chapter II.
The World of Amida Buddha**

75-1

Standing Amida (Amitābha) Buddha

Kamakura period, 13th–14th century

Tanjō-ji Temple, Okayama

① – ④

75-2

Votive Objects Deposited in Standing Amida Statue (Woodblock Printed Buddhas)

Kamakura period, 13th–14th century

Tanjō-ji Temple, Okayama

① – ④

76-1 ◎

Standing Amida (Amitābha) Buddha

Kamakura period, dated 1212 (Kenryaku 2)

Jōdo Shū

⑤ – ⑧

76-2 ◎

Votive Objects Deposited in Standing Amida Statue (Vow to Erect Amitābha Statue by Genchi; List of Donors including Minamoto no Yoritomo)

Kamakura period, dated 1212 (Kenryaku 2)

Jōdo Shū

⑤ – ⑧

77 ◎

Standing Amida (Amitābha) Buddha

Kamakura period, 12th–13th century

Chion-in Temple, Kyoto

⑤ – ⑧

78 ◎

Standing Amida (Amitābha) Buddha

Kamakura period, 13th century

Jōtoku-ji Temple, Kyoto

① – ④

81 ◎

Amida (Amitābha) with Attending Bodhisattvas (Zenkō-ji Style)

Kamakura period, 13th century

Iwaki City, Fukushima

① – ④

82 ◎

Amida (Amitābha) with Attending Bodhisattvas (Zenkō-ji Style)

Kamakura period, dated 1254 (Kenchō 6)

Tokyo National Museum

⑤ – ⑧

83

Seated Amida (Amitābha) Buddha

Kamakura period, 13th century

Amida-ji Temple, Kyoto

85 ◎

Family Altar with Rosewood Finish (Containing Welcoming Descent of Amida Triad)

Family altar and Bodhisattvas: Kamakura period, 13th century

Amida (Amitābha): Edo period, 17th century

Sentai-ji Temple, Nara

87

Bodhisattva Masks

Masks I, II, III: Kamakura period, 13th century

Mask VI: Muromachi period, 16th century

Taima-dera Temple, Nara

88 ●

Welcoming Descent of Amida (Amitābha) and Twenty-five Bodhisattvas, Known as *Haya Raigō* (the “Rapid Welcoming Descent”)

Kamakura period, 14th century

Chion-in Temple, Kyoto

① – ④

96 ◎

Welcoming Descent of the Amida (Amitābha) Triad

Kamakura period, 14th century

Iwaki City, Fukushima

⑤ – ⑧

98

Embroidered Welcoming Descent of the Amida (Amitābha) Triad Embroidery

Kamakura–Nanbokuchō period, 14th century

Chūgū-ji Temple, Nara

① – ④

99

Embroidered Welcoming Descent of the Amida (Amitābha) Triad

Nanbokuchō–Muromachi period, 14th–15th century

Nara National Museum

⑤ – ⑧

100 ◎

Embroidered Amida *Myōgo* (Sacred Name of Amitābha Buddha)

Kamakura–Nanbokuchō period, 14th century

Amida-ji Temple, Fukushima

① – ④

101 ㊦
Amida (Amitābha) Buddha
Kamakura period, 13th century
Hōshin-ji Temple, Kanagawa

⑤ – ⑧

105-1 ㊦
Amida (Amitābha) Coming over the Mountains

Kamakura period, 13th century
Konkai Kōmyō-ji Temple, Kyoto

① – ④

105-2
Five-Colored Strings; Document of Provenance

Five-colored strings: Muromachi period, 15th–16th century
Document of provenance: Muromachi period, dated 1506 (Eishō 3)
Konkai Kōmyō-ji Temple, Kyoto

① – ④

106 ㊦
Amida's Western Paradise and Hell

Kamakura period, 13th–14th century
Konkai Kōmyō-ji Temple, Kyoto

① – ④

107 ㊦
The Ten Realms
Kamakura period, 13th century
Eikan-dō Zenrin-ji Temple, Kyoto

⑤ – ⑧

Chapter III. Hōnen's Disciples and Their Lineages

112 ㊦
Taima Mandala
China, Tang dynasty or Japan, Nara period, 8th century
Taima-dera Temple, Nara

① – ③

113 ㊦
Taima Mandala (Jōkyō Version)
By Aoki Ryōkei (n.d.) and Sōkei (n.d.)
Edo period, dated 1686 (Jōkyō 3)
Taima-dera Temple, Nara

④ – ⑧

116 ㊦
Taima Mandala
Kamakura period, 13th–14th century
Kyushu National Museum

⑤ – ⑧

117
Taima Mandala
Kamakura period, 14th century
Tokyo National Museum

① – ④

118 ㊦
Illustrated Origin of the Taima Mandala (Taima Mandara engi emaki)

Kamakura period, 13th century
Kōmyō-ji Temple, Kanagawa

Volume 1: ① – ④

Volume 2: ⑤ – ⑧

119 ㊦
Illustrated Origin of the Taima Mandala (Taima Mandara engi-e)

Kamakura period, 14th century
Taima-dera Temple, Nara

① – ④

120 ㊦
Origin of Taima Mandala (Taima Mandara engi)
Kamakura period, dated 1262 (Kōchō 2)
Eikan-dō Zenrin-ji Temple, Kyoto

⑤ – ⑧

123
Portrait of Master Shōkū
Muromachi period, 15th century
Seigan-ji Temple, Kyoto

⑤ – ⑧

124
Pensive Portrait of Master Shōkū
Muromachi period, 15th–16th century
Eikan-dō Zenrin-ji Temple, Kyoto

① – ④

126 ㊦
Letters by Genkū (Hōnen), Shōkū, and Other Priests

Kamakura period, 13th century
Kōzen-ji Temple, Nara

⑤ – ⑧

128
Illustrated Biography of Master Shōkū (Shōkū Shōnin e-den)

Muromachi period, dated 1531 (Kyōroku 4)
Jōkyō-ji Temple, Hyogo

Volume 2: ① – ④

Volume 1: ⑤ – ⑧

131 ㊦
Seated Portrait of Master Shōkō
Kamakura period, 13th century
Zendō-ji Temple (Kurume City), Fukuoka

① – ④

134
Handprint Confirmation of the Nenbutsu Teaching (Matsudai nenbutsu jushuin), Shōgokuraku Version

Kamakura period, dated 1228 (Antei 2)
Zendō-ji Temple (Kurume City), Fukuoka

① – ④

135
Handprint Confirmation of the Nenbutsu Teaching (Matsudai nenbutsu jushuin), Genshin Version

Kamakura period, dated 1316 (Shōwa 5)
Shōjōke-in Temple, Kyoto

⑤ – ⑧

136
Lotus Sutra Transcribed in Blood, Volume 8

Kamakura period, dated 1240 (Ninji 1)
Zendō-ji Temple (Kurume City), Fukuoka

⑤ – ⑧

137
Portrait of Master Ryōchū

By Reishun (n.d.)
Meiji period, 19th century
Kōmyō-ji Temple, Kanagawa

138
Conferral of Teachings Certificate from Ryōchū

Kamakura period, 1286 (Kōan 9)
Kōmyō-ji Temple, Kanagawa

⑤ – ⑧

139
Deed of Transfer and Conferral of Teachings Certificate from Ryōchū to His Son Ryōgyō

Kamakura period
1) The eighth month of 1286 (Kōan 9)
2) The sixth day of the ninth month of 1286 (Kōan 9)
3) The sixth month of 1287 (Kōan 10)
4) The sixteenth day of the first month of 1272 (Bun'ei 9)

Kōmyō-ji Temple, Kanagawa

① – ④

140
Portrait of Master Shōgei

Hymns by Jōgetsu (1687–1771)
Edo period, 18th century
Zōjō-ji Temple, Tokyo

⑤ – ⑧

141
Portrait of Master Shōgei

Edo period, 18th–19th century
Hosshō-ji Temple, Ibaraki

① – ④

143
Ritual Procedures for Conferring the Bodhisattva Precepts (Ch: Shou pusajie yi ze)

By Shōgei (1341–1420)
Muromachi period, dated 1409 (Ōei 16)
Jōfuku-ji Temple, Ibaraki

① – ④ / ⑤ – ⑧

144

Personal Annotations on The Chronicles of Japan (Nihon shoki shishō)

By Dōyo (n.d.)
Muromachi period, 14th–15th century
Jōfuku-ji Temple, Ibaraki

Volumes 1 and 2: ① – ④
Volume 3: ⑤ – ⑧

145

Portrait of Master Shōsō

Hymns by Unga (1642–1710)
Edo period, 17th–18th century
Zōjō-ji Temple, Tokyo

146

The Seven Books of Jōdo Shū

By Shōgei (1341–1420), compiled by Shōsō (1366–1440)
Muromachi period, 15th century
Zōjō-ji Temple, Tokyo

150

Rules and Regulations by the Temple Founder

By Seiyo Gutei (1444–1516)
Muromachi period, 15th century
Daiju-ji Temple, Aichi

① – ④

151

One Sheet Document (Ichimai kishōmon)

By Emperor Go-Kashiwabara (1464–1526)
Muromachi period, dated 1522 (Daiei 2)
Hyakumanben Chion-ji Temple, Kyoto

① – ④

152

One Sheet Document (Ichimai kishōmon)

By Ashikaga Yoshiteru (1536–1565)
Muromachi period, dated 1560 (Eiroku 3)
Chion-in Temple, Kyoto

⑤ – ⑧

153 ①

Amida (Amitābha) Triad in Portable Altar

Amida Triad: Kamakura period, 13th century
Portable Altar: Muromachi period, 16th century
Hōon-ji Temple, Kyoto

⑤ – ⑧

158

Illustrated Origin of Jūnen-ji Temple (Jūnenji engi emaki)

By Tosa Mitsumochi (1496–?)
Muromachi period, 16th century
Jūnen-ji Temple, Kyoto

Volume 1: ① – ④
Volume 2: ⑤ – ⑧

159

Illustrated Origin of Nison-in Temple (Nison'in engi emaki)

Muromachi period, 16th century
Nison-in Temple, Kyoto

Volume 1: ① – ④
Volume 2: ⑤ – ⑧

**Chapter IV.
The Pure Land Sect in the Edo Period**

165 ①

Seated Portrait of Tokugawa Ieyasu

Edo period, 17th century
Chion-in Temple, Kyoto

③ – ⑧

167

Seated Portrait of Man'yo Sonshō

Edo period, 17th century
Chion-in Temple, Kyoto

③ – ⑧

168 ①

Chinese Buddhist Canon, Song-Dynasty Edition

1. *Śāriputrābhidharma*, Volume 3
 2. *The Continued Biographies of Eminent Priests*, Volume 29
 3. *Compilation of Worship and Repentance Rituals in Various Sutras*, Volume 2
 4. *Vajrapāṇi Bodhisattva Subduing All Heretics in the Great Teachings King Sutra*, Volume 1
- China, Southern Song dynasty, 12th century
Chion-in Temple, Kyoto

① – ④ / ⑤ – ⑧

170

Eight Heavenly Beings: Taishakuten (Indra), Jikokuten (Dhṛtarāṣṭra), Kongō Rikishi (Vajrapāṇi), and Mitsujaku Rikishi

By Kōnyo (n.d.), Matabē (n.d.), et al.
Edo period, dated 1621 (Genna 7)
Chion-in Temple, Kyoto

172

A Comprehensive Regulation of the Pure Land Sect (Jōdoshū sho hatto) from the seventh month of Genna 1 (1615)

Edo period, dated 1615 (Genna 1)
Chion-in Temple, Kyoto

① – ④

173

A Comprehensive Regulation of the Pure Land Sect (Jōdoshū sho hatto) from the twenty-eighth day of the sixth month of Genna 4 (1618)

Edo period, dated 1618 (Genna 4)
Chion-in Temple, Kyoto

⑤ – ⑧

174

A Comprehensive Regulation of the Pure Land Sect (Jōdoshū sho hatto) from the seventh month of Genna 1 (1615)

Edo period, dated 1615 (Genna 1)
Zōjō-ji Temple, Tokyo

① – ④

175 ①

Chinese Buddhist Canon, Song-Dynasty Edition

1. *Lotus Sutra*, Volume 7
2. *Sutra on the Establishment of the Mindfulness of the Right Dharma*, Volume 40
3. *Discourse on the Path to Liberation*, Volume 1
4. *Sutra on the Bodhisattva Practice*, Volume 1
5. Storage Box No. 23 (for sixty-one accordion books)

China, Northern Song–Southern Song dynasty, printed 12th century
Zōjō-ji Temple, Tokyo

① – ④ / ⑤ – ⑧

176 ①

Chinese Buddhist Canon, Yuan-Dynasty Edition

1. *The Mahāyāna Great Collection Sutra on the Ten Wheels of Kṣitigarbha*, Volume 10
2. *Flower Garland Sutra*, Volume 1
3. “Chapter on the Conduct and Vows of Samantabhadra” from the *Avatamsaka Sūtra*
4. *Mahāsātya-nirgrantha-sūtra* (Ch: *Dasazhe nijianzi suoshuo jing*), Volume 10
5. Storage Box No. 55 (for twenty-two accordion books)

China, Yuan dynasty, printed 13th century
Zōjō-ji Temple, Tokyo

① – ④ / ⑤ – ⑧

177 ①

Korean Buddhist Canon, Goryeo-Dynasty Edition

1. *Mahāprajñāpāramitā Mahāvidyā Sūtra*
2. *Special Revised Catalogue for the Newly Carved Goryeo Dynasty Tripitaka*, Volumes 21–25
3. *Tripitaka Catalogue*, Volumes 1–3
4. *The Pronunciation and Meaning of the Complete Buddhist Canon*, Volumes 98–100
5. Storage Box No. 18 (for eleven accordion books)

Korea, Goryeo dynasty, printed 13th century
Zōjō-ji Temple, Tokyo

① – ④ / ⑤ – ⑧

179

Daily Recitation of Nenbutsu (Nikka nenbutsu)

Attributed to Tokugawa Ieyasu (1542–1616)
Edo period, 17th century
Tokyo National Museum

180

The Three Pure Land Sutras (Jōdo sanbukyō)

Sutra on the Buddha of Infinite Life, Volumes 1 and 2; *Contemplation Sutra*; *Amitābha Sutra*
Edo period, 17th century
Gugyō-ji Temple (Jōsō City), Ibaraki

① – ④ / ⑤ – ⑧

181

Buddha Entering Nirvana with Sacred Assembly and Animals

Edo period, 17th century
Hōnen-ji Temple, Kagawa

182
Portrait of Master Taichū
 By Ryūkyū King Shō Nei (1564–1620)
 Edo period, dated 1611 (Keichō 16)
 Dannō Hōrin-ji Temple, Kyoto
 ① – ④

183
Plaque with Instructions for the Family of Sima Guang
 Ryūkyū Kingdom, Second Shō dynasty, before 1611
 Dannō Hōrin-ji Temple, Kyoto
 ① – ④

184-1
Scene of Nerikuyō Procession at Taima-dera Temple
 By Tōkichi (n.d.) and Tōzō (n.d.)
 Edo period, dated 1621 (Genna 7)
 Saiju-ji Temple, Kyoto
 ① – ④

186
Imperial Presentation of the Posthumous Name “Great Master Enkō” to Master Hōnen (Zō Enkō Daishi gō ekotoba)
 By Myōyo Kokan (1653–1717)
 Edo period, dated 1697 (Genroku 10)
 Chion-in Temple, Kyoto
 Volume 1: ① – ③
 Volume 3: ④ ⑤
 Volume 2: ⑥ – ⑧

187
Embroidered Illustrated Biography of Master Hōnen (Hōnen Shōnin e-den)
 Edo period, 17th century
 Isshin-ji Temple, Osaka
 ⑤ – ⑧

188
Seated Portrait of Master Yūten
 By Takezaki Iwami (n.d.)
 Edo period, dated 1719 (Kyōhō 4)
 Yūten-ji Temple, Tokyo

189
Taima Mandala; Portrait of Master Yūten (in Portable Altar)
 Edo period, 1722 (Kyōhō 7) or later
 Yūten-ji Temple, Tokyo

190
Myōgo (Sacred Name of Amida Buddha) in the Form of a Jeweled Stupa
 By Yūten (1637–1718)
 Edo period, dated 1699–1700 (Genroku 12–13)
 Yūten-ji Temple, Tokyo

191
Ten Nenbutsu Myōgo (Sacred Name of Amida Buddha)
 By Yūten (1637–1718)
 Edo period, dated 1700–1704 (Genroku 13–Hōei 1)
 Yūten-ji Temple, Tokyo

192
Six-Character Myōgo (Sacred Name of Amida Buddha)
 By Yūten (1637–1718)
 Edo period, 17th–18th century
 Yūten-ji Temple, Tokyo

193
Amida (Amitābha) with Six Character Myōgo (Sacred Name of Amitābha Buddha)
 By Yūten (1637–1718)
 Edo period, 17th–18th century
 Yūten-ji Temple, Tokyo

194
Five Hundred Arhats
 By Kanō Kazunobu (1816–1863)
 Edo period, 19th century
 Zōjō-ji Temple, Tokyo
 Hanging scrolls 11, 12, 23, 24, 41, 42, 59, 60, 63, 64, 81, and 82:
 ① – ④
 Hanging scrolls 17, 18, 27, 28, 57, 58, 69, 70, 79, 80, 83, and 84:
 ⑤ – ⑧

Heiseikan 2F

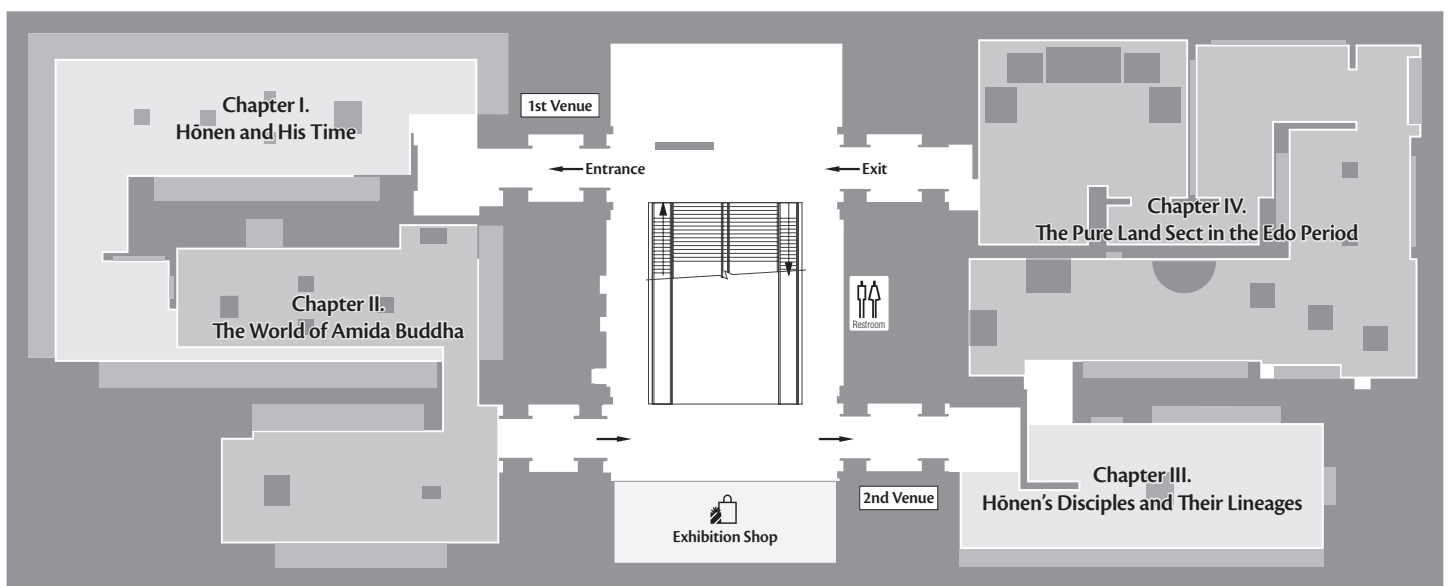

* Temperature, humidity and brightness of the exhibition rooms are strictly controlled under international standards for preservation. We apologize for any inconvenience this may cause.

