

Special Exhibition Commemorating  
the 1150th Founding Anniversary of Daikakuji

List of Works

# Treasures of Daikakuji

From Imperial Villa to Buddhist Temple

January 21 – March 16, 2025 | Heiseikan, Tokyo National Museum 

Organizers:

Tokyo National Museum, Daikakuji Temple, The Yomiuri Shimbun,  
Nippon Television Network Corporation, BS Nippon Corporation

With the special sponsorship of:

Canon Inc., Daiwa Securities Group, T&D Insurance Group,  
Meiji Holdings Co., Ltd.

With the sponsorship of:

East Japan Railway Company, SHIMIZU CORPORATION,  
TAKENAKA CORPORATION, Sumitomo Mitsui Banking Corporation,  
Mitsui Fudosan Co., Ltd., MITSUBISHI GAS CHEMICAL CO., INC.,  
MITSUBISHI ESTATE CO., LTD., Mitsubishi Corporation

With the special support of:

Agency for Cultural Affairs

With the support of:

MITSUMURA PRINTING Co., Ltd.

Notes

- The same artwork numbers are used in both the catalogue and the galleries, but the works are not displayed in numerical order.
- Key to symbols on illustrations:  
●=National Treasure, ◎=Important Cultural Property.
- Some artworks may be rotated during the exhibition period. Exhibition lineup may change as circumstances require.
- Artworks are on view throughout the exhibition period unless otherwise indicated.

The rotation schedule is as follows:

Term① 1/21 (Tue.) – 2/16 (Sun.)

Term② 2/18 (Tue.) – 3/16 (Sun.)

A part of the proceeds from the exhibition will be used as part of the TSUMUGU Project to help conserve Japan's cultural properties.



## Chapter 1 Emperor Saga and Kūkai — From Saga-in to Daikakuji

1

### Emperor Saga

Kamakura period, 14th century  
Imperial Household Agency

Ⓐ Term①

2

### Emperor Saga

Edo period, 18th century  
Daikakuji Temple, Kyoto

Ⓐ Term②

3

### The Monk Kūkai (Kōbō Daishi)

Kamakura period, 14th century  
Daikakuji Temple, Kyoto

Ⓐ

4

### Six Sheets of Kūkai's Teachings Recorded by His Disciple Shinga

Attributed to Shinga

Six sheets

Kamakura to Nanbokuchō period, 14th century  
Daikakuji Temple, Kyoto

Ⓐ

5

### Part of the Sovereign Kings Sutra, Vol. 6

Attributed to Kūkai

Nara period, 8th century  
Daikakuji Temple, Kyoto

Ⓐ

6-1

### Documents Related to the Heart Sutra Sealed by Imperial Decree Account of the Dedication Ceremony Held in Shōgen I (1259) for the Heart Sutra Sealed by Imperial Decree

By Yūnen

Muromachi period, 1461  
Daikakuji Temple, Kyoto

Ⓐ

6-2

### Documents Related to the Heart Sutra Sealed by Imperial Decree Record of Unsealing the Heart Sutra Sealed by Imperial Decree

By Kūshō

Edo period, 17th century  
Daikakuji Temple, Kyoto

Ⓐ

7-1

### ◎ The Five Great Wisdom Kings: The Wisdom King Fudō (Acalanātha)

By Inshin

Muromachi period, 1501  
Daikakuji Temple, Kyoto

Ⓐ

7-2

### The Five Great Wisdom Kings: The Wisdom King Gōzanze (Trailokyavijaya)

Edo period, 17th–18th century  
Daikakuji Temple, Kyoto

Ⓐ

7-3

### ◎ The Five Great Wisdom Kings: The Wisdom King Gundari (Kuṇḍali)

By Inshin

Muromachi period, 1501  
Daikakuji Temple, Kyoto

Ⓐ

7-4

### ◎ The Five Great Wisdom Kings: The Wisdom King Daiitoku (Yamāntaka)

By Inshin

Muromachi period, 1501  
Daikakuji Temple, Kyoto

Ⓐ

7-5

**The Five Great Wisdom Kings:  
The Wisdom King Kongōyasha  
(Vajrayakṣa)**

Edo period, 17th–18th century  
Daikakuji Temple, Kyoto

(A)

8

**Materials Related to the Monk Ichimu  
Shinkō (Deposited in a Statue of the  
Wisdom King Daiitoku)**

Five of forty-one objects

- (1) Dharma Transmission Lineage for the Yūzūnenbutsu School: Muromachi period, 1481
- (2) Dharma Transmission Lineage for the Shingon School: Muromachi period, 1496
- (3) The Five Great Wisdom Kings: Muromachi period, 15th–16th century
- (4) The Deity Uhō Dōji: Muromachi period, 15th–16th century
- (5) The Bodhisattva Kokūzō (Ākāśagarbha): Muromachi period, 15th–16th century

Daikakuji Temple, Kyoto

(A) Term①:(2)(3)(4) / Term②:(1)(5)

9-1

**The Five Great Wisdom Kings:  
The Wisdom King Fudō (Acalanātha)**

By Myōen

Heian period, 12th century  
Daikakuji Temple, Kyoto

(A)

9-2

**The Five Great Wisdom Kings:  
The Wisdom King Gōzanze  
(Trailokyavijaya)**

By Myōen

Heian period, 12th century  
Daikakuji Temple, Kyoto

(A)

9-3

**The Five Great Wisdom Kings:  
The Wisdom King Gundari (Kuṇḍali)**

By Myōen

Heian period, 1177  
Daikakuji Temple, Kyoto

(A)

9-4

**The Five Great Wisdom Kings:  
The Wisdom King Daiitoku (Yamāntaka)**

By Myōen

Heian period, 12th century  
Daikakuji Temple, Kyoto

(A)

9-5

**The Five Great Wisdom Kings:  
The Wisdom King Kongōyasha (Vajrayakṣa)**

By Myōen

Heian period, 1176  
Daikakuji Temple, Kyoto

(A)

10

**The Wisdom King Aizen (Rāgarāja)**

Kamakura period, 1328  
Daikakuji Temple, Kyoto

(A)

11

**The Five Great Manifestations of the  
Bodhisattva Kokūzō (Ākāśagarbha)**

Kamakura period, 13th century  
Daikakuji Temple, Kyoto

(A) Term①

12

**Mandala of the Principles of Wisdom  
Sutra**

Kamakura period, 13th century  
Daikakuji Temple, Kyoto

(A) Term②

**Chapter 2**

**Emperor Go-Uda and  
the Advent of the “Saga Palace”**

13

**Drawing of Daikakuji Temple’s Precincts**

Edo period, 18th–19th century  
Daikakuji Temple, Kyoto

(B)

14

**Emperor Go-Uda**

Kamakura period, 14th century  
Daikakuji Temple, Kyoto

(B) Term①

15

**Retired Emperor Go-Uda**

Kamakura period, 14th century  
Daikakuji Temple, Kyoto

(B) Term①

16

**Retired Emperor Go-Uda**

Muromachi period, 15th century  
Daikakuji Temple, Kyoto

(B) Term②

17

**Biography of the Monk Kūkai  
(Kōbō Daishi) in Emperor Go-Uda’s  
Handwriting**

By Emperor Go-Uda

Kamakura period, 1315  
Daikakuji Temple, Kyoto

(B) Term①

18

**Last Will and Testament in Emperor  
Go-Uda’s Handwriting with His  
Handprints**

By Emperor Go-Uda

Kamakura period, 14th century  
Daikakuji Temple, Kyoto

(B) Term②

19

**Ritual Protocols for Individual Deities  
(Hishō, “Secret Excerpts”), Called the  
“Blue Sutra Cover” Version**

Two of 129 handscrolls  
Heian to Kamakura period, 12th–13th century  
Daikakuji Temple, Kyoto

(B) Term① / Term②

20

**Mudras and Mantras for the Abhiṣeka  
Rite in Emperor Go-Uda’s Handwriting**

By Emperor Go-Uda

Two of six handscrolls  
Kamakura period, 1308  
Daikakuji Temple, Kyoto

(B) Term① / Term②

21

**Secret Teachings of the Homa Fire  
Ritual in Emperor Go-Uda’s Handwriting**

By Emperor Go-Uda

Kamakura period, 14th century  
Daikakuji Temple, Kyoto

(B) Term①

22

**The Monk Hōjō’s Notes on the Abhiṣeka  
Rite in Emperor Go-Uda’s Handwriting,  
Vol. 1**

By Emperor Go-Uda

Kamakura period, 1314  
Daikakuji Temple, Kyoto

(B) Term①

**Chapter 3**

**Successive Emperors and  
Court Culture**

23

**The Monk Gishun**

Azuchi-Momoyama period, 16th–17th century  
Daikakuji Temple, Kyoto

(C)

24

**The Tale of Genji  
(Daikakuji Temple Version)**

Vol. 1 “The Paulownia Court” by

Prince Fushimi Sadaatsu

Vol. 11 “The Orange Blossoms” by

Sanjōnishi Sanetaka

Vol. 13 “Akashi” by Sanjōnishi Kin’eda

Vol. 20 “The Morning Glory” by

the daughter of Imadegawa Norisue

Vol. 51 “A Boat upon the Waters” by

Prince Fushimi Sadaatsu

Vol. 54 “The Floating Bridge of Dreams” by

Sanjōnishi Sanetaka with afterword by

Sanjōnishi Kin’eda

Six of forty-six volumes

Muromachi period, 16th century

Daikakuji Temple, Kyoto

(C)

25

**Register of Calligraphers for The Tale of  
Genji**

Muromachi period, 16th century

Daikakuji Temple, Kyoto

(C)

26

**Prince Sonshō**

Edo period, 17th century  
Daikakuji Temple, Kyoto

(C) Term①

27

**Letter**

By Takatsukasa Norihira

Edo period, 17th century

Daikakuji Temple, Kyoto

© Term②

28

**The Monk Kanshu**

By Watanabe Shikō

Edo period, 18th century

Daikakuji Temple, Kyoto

©

29

**Box for the Ten-Round Incense Game with Young Pines**

Edo period, 19th century

Daikakuji Temple, Kyoto

©

30

**Emperor Takakura**

Inscription by Emperor Go-Tsuchimikado

Muromachi period, 15th century

Daikakuji Temple, Kyoto

© Term①

31

**Waka Poem**

By Emperor Go-Mizunoo

Edo period, 17th century

Daikakuji Temple, Kyoto

© Term②

32-1

**Official Document with Oda Nobunaga's Seal Addressed to the Abbot's Clerk at Daikakuji Temple**

Muromachi period, 1568

Daikakuji Temple, Kyoto

© Term①

32-2

**Official Document with Oda Nobunaga's Seal Addressed to Daikakuji Temple**

Azuchi-Momoyama period, 1575

Daikakuji Temple, Kyoto

© Term②

33-1

**Official Document from Toyotomi Hideyoshi Concerning the Seating Order of Imperial Princes and Figures with the Imperial Rank Jugō**

Azuchi-Momoyama period, 1585

Daikakuji Temple, Kyoto

© Term①

33-2

**Official Document from Toyotomi Hideyoshi Addressed to Daikakuji Temple**

Azuchi-Momoyama period, 1588

Daikakuji Temple, Kyoto

© Term②

34

**Official Document from Tokugawa Hidetada to Daikakuji Temple Recognizing Land Ownership**

Edo period, 1617

Daikakuji Temple, Kyoto

©

35

**© Blade for a Long Sword (*Tachi*), Named "Usumidori" and "Hizamaru"**

Kamakura period, 13th century

Daikakuji Temple, Kyoto

©

36

**Ownership History of the Long Sword (*Tachi*) Named "Usumidori"**

Edo period, 17th–18th century

Daikakuji Temple, Kyoto

©

37

**© Blade for a Long Sword (*Tachi*), Named "Onikirimaru" and "Higekiri"**

Heian to Kamakura period, 12th–14th century

Kitano Tenmangū Shrine, Kyoto

©

38

**Album of Agreements**

Foreword by Ryūchi Mitsuō

Taishō era, 1922

Daikakuji Temple, Kyoto

©

**Chapter 4  
Sliding Door Paintings  
for the Empress's Residence  
— The Shōshinden and Shinden**

39

**© Pheasants and Pines**

Entryway of Matsu-no-ma ("Pine Room")

Two of twelve panels

Edo period, 17th century

Daikakuji Temple, Kyoto

©

40

**© Landscape**

Okanmuri-no-ma ("Crown Room"), Shōshinden

By Kanō Sanraku

Seventeen of twenty panels

Azuchi-Momoyama to Edo period,

16th–17th century

Daikakuji Temple, Kyoto

© Term①: 17 panels / Term②: 13 panels

41

**© Ornamental Doorframe Components with Paulownia and Bamboo**

Azuchi-Momoyama to Edo period,

16th–17th century

Daikakuji Temple, Kyoto

©

42

**© Sliding Door Pulls for the Shōshinden Yuki-no-ma ("Snow Room"), Shōshinden**

Two door pulls

Edo period, 17th century

Daikakuji Temple, Kyoto

©

43

**© Maple and Willow**

Momiji-no-ma ("Maple Room"), Shōshinden

Attributed to Kanō Sanraku

Four panels

Azuchi-Momoyama to Edo period,

16th–17th century

Daikakuji Temple, Kyoto

© Term②

44

**© Peach Trees and Bamboo Momiji-no-ma ("Maple Room") and Take-no-ma ("Bamboo Room"), Shōshinden**

Attributed to Kanō Sanraku

Seven panels

Azuchi-Momoyama to Edo period,

16th–17th century

Daikakuji Temple, Kyoto

© Term②

45

**© Bamboo**

Take-no-ma ("Bamboo Room"), Shōshinden

Attributed to Kanō Sanraku

Four panels

Azuchi-Momoyama to Edo period,

16th–17th century

Daikakuji Temple, Kyoto

© Term②

46

**© Trees**

Momiji-no-ma ("Maple Room"), Shōshinden

Four panels

Azuchi-Momoyama to Edo period,

16th–17th century

Daikakuji Temple, Kyoto

© Term①

47

**© Hawks and Pines**

Taka-no-ma ("Hawk Room"), Shōshinden

By Kanō Sanraku

Thirteen panels

Azuchi-Momoyama to Edo period,

16th–17th century

Daikakuji Temple, Kyoto

© Term①

48

**© Snowy Landscape**

Yuki-no-ma ("Snow Room"), Shōshinden

By Watanabe Shikō

Four of nineteen panels

Edo period, 18th century

Daikakuji Temple, Kyoto

© Term②

49

◎ **The Seven Sages of the Bamboo Grove**  
**Kenjin-no-ma** (“Sage Room”), Shōshinden  
 Attributed to Watanabe Shikō  
 Eight of fourteen panels  
 Edo period, 18th century  
 Daikakuji Temple, Kyoto  
 ㊦ Term①: 4 panels / Term②: 8 panels

50

◎ **Hares**  
**East Corridor**, Shōshinden  
 By Watanabe Shikō  
 Twelve panels  
 Edo period, 18th century  
 Daikakuji Temple, Kyoto  
 ㊦

51

◎ **Banana Trees**  
 By Watanabe Shikō  
 Two panels  
 Edo period, 18th century  
 Daikakuji Temple, Kyoto  
 ㊦

52

◎ **Cranes**  
 By Watanabe Shikō  
 Two panels  
 Edo period, 18th century  
 Daikakuji Temple, Kyoto  
 ㊦

53

◎ **Peonies**  
**Botan-no-ma** (“Peony Room”), Shinden  
 By Kanō Sanraku  
 Eighteen panels  
 Edo period, 17th century  
 Daikakuji Temple, Kyoto  
 ㊦

54

◎ **Red and White Plum Blossoms**  
**Kōbai-no-ma** (“Red Plum Blossom Room”), Shinden  
 By Kanō Sanraku  
 Eight panels  
 Edo period, 17th century  
 Daikakuji Temple, Kyoto  
 ㊦

55

◎ **Swallows and Willows**  
**Kōbai-no-ma** (“Red Plum Blossom Room”), Shinden  
 Eight panels  
 Azuchi-Momoyama to Edo period,  
 16th–17th century  
 Daikakuji Temple, Kyoto  
 ㊦

56

◎ **Willows and Cherry Trees**  
**Yanagimatsu-no-ma** (“Willow-Pine Room”), Shinden  
 Six panels  
 Azuchi-Momoyama to Edo period,  
 16th–17th century  
 Daikakuji Temple, Kyoto  
 ㊦

57

◎ **Cranes and Pines**  
**Yanagimatsu-no-ma** (“Willow-Pine Room”), Shinden  
 Four panels  
 Azuchi-Momoyama to Edo period,  
 16th–17th century  
 Daikakuji Temple, Kyoto  
 ㊦

## Floor Plan | Heiseikan 2F

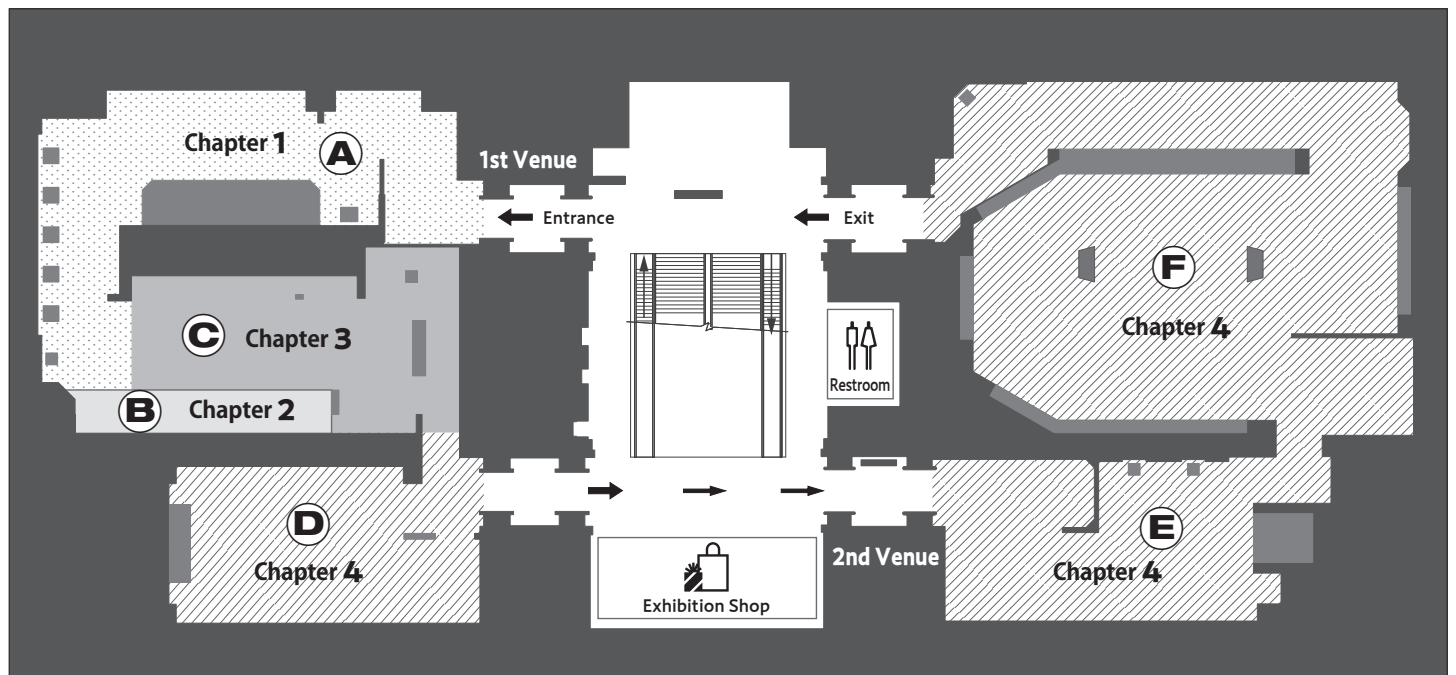

\* Temperature, humidity, and brightness of the exhibition rooms are strictly controlled under international standards for preservation. We apologize for any inconvenience this may cause.



### Photography Allowed for Chapter Four Only

Photography is permitted only for works in Chapter Four of this exhibition.  
 \*Photography is prohibited for works in Chapters 1–3.



Photographs may be used for non-commercial purposes only. Sharing on social media is OK!  
 Please refrain from using flash, tripods, or similar equipment.  
 Photography may be subject to additional restrictions at the organizers' discretion.